

USER GUIDE

FlexClean®
all-in-one floor cleaner

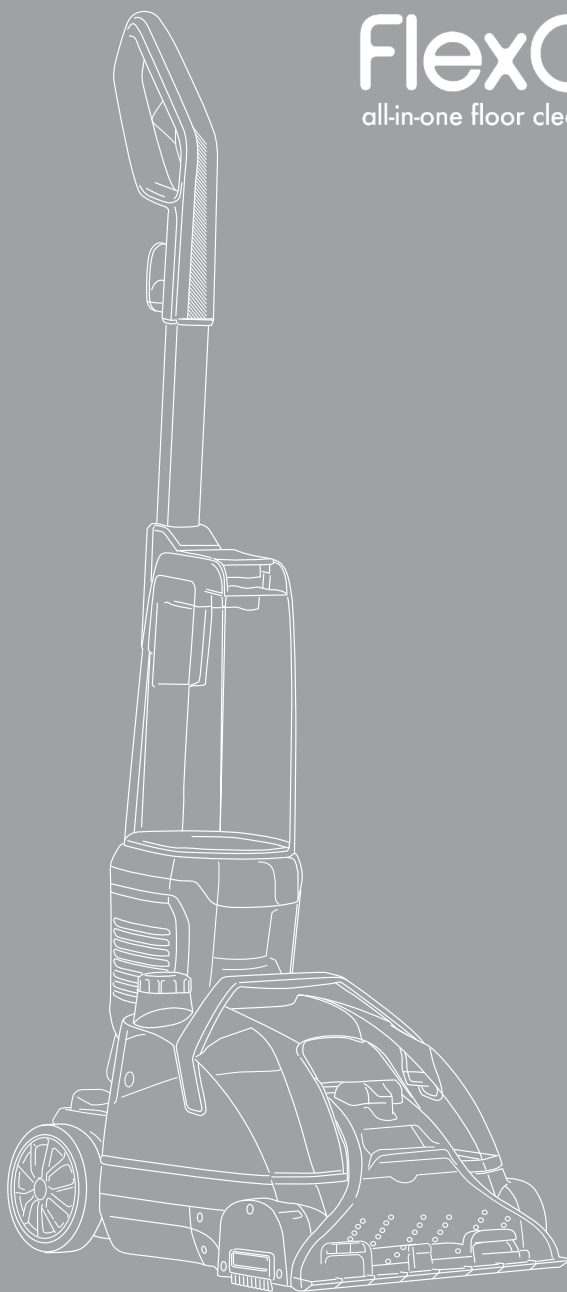

RugDoctor

GUIDE CONTENTS

- 3 | Safety Instructions
- 4 | Product Parts & Components
- 5 | Assembly
- 6 | Flow Control Dial
- 7 | Getting Started – Filling the Clean Water Tank
- 8 | Cleaning Carpets
- 9 | Cleaning Hard Floors
- 10 | Emptying the Dirty Water Tank
- 11 | Cleaning Up
- 13 | Troubleshooting
- 14 | Warranty Information

Retain for your records: To save time if calling Customer Service for information about your Rug Doctor Machine, it is recommended that you record your machine information here::

SERIAL # _____

DATE OF PURCHASE: _____

Rug Doctor

Founded by a professional carpet cleaner in 1972, Rug Doctor began with machines designed and built specifically for professional use. Shortly after, the brand introduced the first hire program, making professional-grade carpet cleaning machines accessible to the public. Over 50 years later, Rug Doctor has become a household name, continuing to lead the industry in hire systems with its powerful and innovative products.

SAFETY INSTRUCTIONS



WARNING – to reduce the risk of fire, electric shock, injury or property damage:

Please read all instructions before using. When using an electrical appliance, basic precautions should always be followed, including the following:

- To prevent scalding or burns, exercise caution when filling the clean water tank with hand-hot tap water. Do not use boiled or microwaved water in the machine.
- Do not leave the machine unattended when plugged in or while it is on. Unplug from the power outlet when not in use and before cleaning or servicing.
- To reduce the risk of fire and electric shock due to internal component damage, use only Rug Doctor or recommended cleaning products that are intended for use in the machine.
- This appliance is not intended for use by individuals (including children) with reduced physical, sensory, or mental capabilities, or those lacking experience and knowledge, unless they have been given supervision or instructions on the proper use of the appliance by a person responsible for their safety.
- Use only as described in this User Guide.
- Do not use with damaged power cord or plug. If the power cord is damaged, it must be replaced by the manufacturer, or its service agent in order to avoid a hazard.
- The power cord should not be used to pull or carry the machine, used as a handle, exposed to heated surfaces or pulled around sharp edges or corners.
- Do not unplug by pulling on power cord. To unplug, grasp the plug not the cord.
- Do not handle plug or machine with wet hands.
- Do not put any object into openings. Do not use if any opening is blocked; keep free of dust, lint, hair, and anything that may reduce air flow.
- Keep hair, loose clothing, fingers, and all parts of the body away from openings and moving parts.
- Turn off all controls before unplugging.
- Use extra care when cleaning on stairs.
- Do not use to pick up anything that is burning or smoking, such as cigarettes, matches or hot ashes.
- Do not use to clean up flammable or combustible liquids or materials, such as petrol, solvent, or any caustic or toxic substances like bleach, ammonia, toilet or drain cleaner.
- Use only on surfaces moistened by cleaning process or small spills. Do not place or submerge the machine in standing water or try to clear flooded areas.
- The use of an extension cord is not recommended. Failure to follow the foregoing instructions may expose the user to the possibility of electric shock, personal injury and/or death.
- When the clean water tank runs out stop using and follow the instructions to refill.
- Dispose of dirty water responsibly into a toilet or outside drain, do not pour into sink, bath or shower.
- Do not operate without tanks or in any manner inconsistent with the above warnings or the operating instructions provided in this User Guide.

PRODUCT PARTS & COMPONENTS

RugDoctor®
FlexClean®
 all-in-one floor cleaner

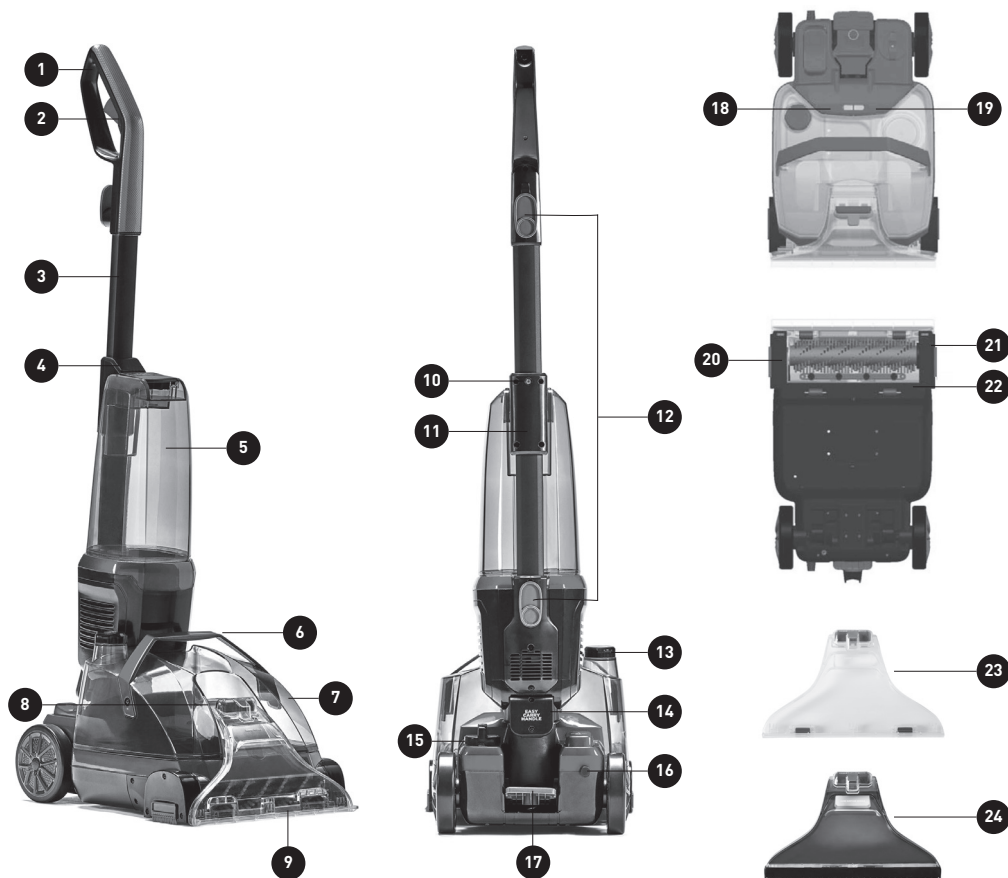

1. Main Handle
2. Spray & Clean Trigger
3. Handle Base
4. Clean Water Tank Release
5. Clean Water Tank
6. Tank Handle
7. Dirty Water Tank
8. Nozzle Release

9. Nozzle
10. Handle Screw
11. Handle Connector
12. Power Cord Wrap
13. Dirty Water Cap
14. Easy Lift Handle
15. Flow Control Dial
16. Power Switch

17. Handle Release
18. Brushroll Jam Indicator
19. Low Solution Indicator
20. Brushroll
21. Brushroll Cover
22. Brushroll Lock
23. Carpet Nozzle
24. Hard Floor Nozzle

ASSEMBLY



WARNING!

DO NOT plug in your FlexClean® All-In-One Floor Cleaner until you are familiar with all instructions and operating procedures.

Your Rug Doctor® FlexClean® All-In-One Floor Cleaner comes in 4 easy-to-assemble components:

- Main Handle
- Soft Surface Nozzle (carpet/rug)
- FlexClean® All-In-One Floor Cleaner
- Hard Surface Nozzle (hard floor)

1

Remove Screw

Use Phillips screwdriver to remove screw in Handle Connector.



2

Insert the Handle

Insert the Main Handle into the Handle Connector.



3

Line up the Hole

Align the hole in the Main Handle with the hole on the Handle Base. Insert the Screw and use a Phillips screwdriver to tighten the Screw by turning clockwise.



*A Phillips screwdriver is required for Steps 1 and 4.

4

Choose One

Attach Carpet Nozzle or Hard Floor Nozzle as per desired area to clean.



Carpet Nozzle



Hard Floor Nozzle

5

Attach the Nozzle

1. Align the nozzle tabs with the slots in the base (in front of the brushroll).
2. Rotate toward machine.
3. Latch the nozzle by pressing down on the top of the nozzle until you hear a "click."

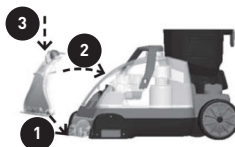

6

Secure The Cord

Wrap the cord around the Power Cord Wrap. Now you are ready to clean.



FLOW CONTROL DIAL

The FlexClean® All-In-One Floor Cleaner is equipped with a helpful indicator light system designed to quickly alert you of issues while cleaning. The FlexClean® All-In-One Floor Cleaner is equipped with two different indicator lights: BRUSH JAM and LOW SOLUTION. The two different indicator lights are located behind the DIRTY WATER TANK.

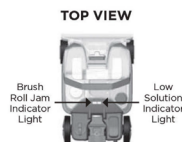

the **BRUSH JAM INDICATOR LIGHT** is triggered when foreign objects become lodged into the BRUSH ROLL, jamming and preventing the BRUSH ROLL from spinning. When the machine detects a jam, the brush motor will shut off and the BRUSH JAM INDICATOR LIGHT will illuminate. The BRUSH JAM INDICATOR LIGHT system protects the machine and prevents belt burn-out.

The **LOW SOLUTION INDICATOR LIGHT** will illuminate if the machine detects the CLEAN WATER TANK is empty. The LOW SOLUTION INDICATOR LIGHT system protects the machine and prevents pump burn-out that could occur if the machine runs dry/without solution.

Removing Brush Roll Jam

- 1 **Illuminated Indicator Light**
The BRUSH JAM INDICATOR LIGHT will illuminate if the machine detects a BRUSH ROLL jam.
- 2 **Access the Brush Roll**
Turn off the machine and unplug the machine from the power outlet.
Remove water tanks.
Gently position the machine on its side to access the BRUSH ROLL
- 3 **Remove the Jam**
Gently remove jammed item from the BRUSH ROLL. Once jammed item is removed, place the machine upright. Replace both tanks, plug in machine and press POWER BUTTON to desired cleaning mode.

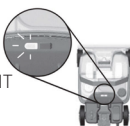

Low Solution Indicator Light

- 1 **Illuminated Low Solution Light**
The LOW SOLUTION INDICATOR LIGHT will illuminate if the machine detects the CLEAN WATER TANK is empty.
- 2 **Add Cleaning Solution**
Refer to "Fill the Clean Water Tank" Instructions on Page 7.
- 3 **Now You Are Ready To Clean**

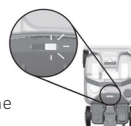

FLOW CONTROL DIAL

The FlexClean® All-In-One Floor Cleaner is equipped with a **Flow Control System** designed to address all of your cleaning needs with one machine.

The three different FLOW CONTROL DIAL settings and usage information are listed as follows:

ATTENTION! DO NOT use DEEP CLEAN mode on hard floors as it will over-wet hard floors

CARPET DEEP CLEAN

USE ONLY FOR SOFT SURFACE CLEANING (carpet/area rugs).



Deep Clean mode delivers a traditional deep clean to your soft surfaces and is recommended to achieve the best deep cleaning results.

IMPORTANT! The **Deep Clean Mode** dispenses three times the solution of the **Hard Floor Clean Mode**.

QUICK DRY

USE ONLY FOR SOFT SURFACE CLEANING (carpet/area rugs).



Quick Dry mode provides a lighter clean by applying less water and cleaning solution and reduces the drying time after cleaning (when compared to DEEP CLEAN mode).

Great for use on carpet, area rugs, and spot cleaning.

HARD FLOOR

USE ONLY FOR SEALED HARD FLOOR CLEANING.



Delivers the perfect amount of solution and water on sealed hard floors such as stone, tile, laminate, vinyl, and sealed hardwood.

GETTING STARTED – FILLING THE CLEAN WATER TANK

1

Locate the clean water tank

The CLEAN WATER TANK is the top tank located on the front of the machine.



2

Remove the clean water tank

Push the CLEAN WATER TANK RELEASE BUTTON and lift the CLEAN WATER TANK in an outward motion.



3

Fill the clean water tank

Turn the CLEAN WATER TANK upside down. Unscrew the CLEAN WATER CAP by turning counter clockwise. Remove CLEAN WATER CAP from the tank and set aside.



!

REMEMBER

Always use Rug Doctor cleaning solutions.

Other cleaning solutions may harm the machine and void the machine warranty.

Fill with hot tap water.

DO NOT USE BOILING WATER! DO NOT HEAT WATER OR TANK IN MICROWAVE!

4

Place the clean water tank

Fill the tank with HOT tap water until it reaches the "Fill" line. Add Rug Doctor All-In-One Cleaning Solution.

[90ml of cleaning solution per tank or 180ml for a deep clean]. CLEAN WATER TANK capacity is 3.7 litres.

Screw the cap back onto the CLEAN WATER TANK by turning clockwise until completely tightened.



5

Place the clean water tank

Turn CLEAN WATER TANK right side up. Securely place onto the machine. You will hear a "click" sound when the tank is locked into place you hear a "click."



6

Now you are ready to clean



CLEANING CARPET



IMPORTANT CLEANING TIP: Vacuum area with dry vacuum cleaner thoroughly before deep cleaning.



CAUTION!

Before plugging in machine, check the **POWER SWITCH** to make sure it is in the “off” position.

1

ATTACH CARPET NOZZLE

If the CARPET NOZZLE is not attached:

1. Align the nozzle tabs with the slots in the base of the machine.
2. Rotate NOZZLE toward machine
3. Latch the NOZZLE by pressing down on the top of the nozzle until you hear a “click.”

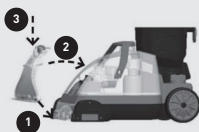

2

SELECT CLEANING MODE

Turn the FLOW CONTROL DIAL to the DEEP CLEAN or QUICK DRY setting based on desired cleaning. Refer to “Flow Control Dial” instructions on Page 6.



3

PLUG IN THE MACHINE

Unwrap the POWER CORD and insert plug into an outlet.



4

POSITION THE MACHINE

Position the MACHINE onto the desired area to clean.



5

TURN MACHINE ON

Push the POWER SWITCH to “FLOOR CLEANING” position.



6

RELEASE THE HANDLE

Step on the HANDLE RELEASE PEDAL to pull back/release the MAIN HANDLE.



7

CLEANING YOUR CARPETS

Press the SPRAY & CLEAN button to apply solution while making 2 slow wet passes (1 forward and 1 backward) over each area. Release SPRAY & CLEAN button. Press Spray & Clean Trigger. Make 2 slow dry passes (1 forward and 1 backward) to suck up the dirty solution (DO NOT hold down the SPRAY & CLEAN button for this step).



8

LEAVE THE MACHINE ON FOR 15 SECONDS

Leave the machine on for 15 seconds after cleaning to allow for all of the dirty solution to be collected into the DIRTY WATER TANK.



CLEANING HARD FLOORS



IMPORTANT CLEANING TIP: Sweep area thoroughly before deep cleaning.



CAUTION!

Before plugging in machine, check the **POWER SWITCH** to make sure it is in the “off” position.

1

TO ATTACH HARD FLOOR NOZZLE

1. Align the nozzle tabs with the slots in the base of the machine.
2. Rotate NOZZLE toward machine.
3. Latch the NOZZLE by pressing down on the top of the NOZZLE until you hear a “click.”

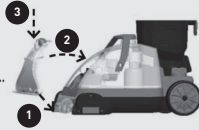

2

SELECT CLEANING MODE

Turn the FLOW CONTROL DIAL to the HARD FLOOR setting.



3

PLUG IN THE MACHINE

Unwrap the POWER CORD and insert plug into an outlet.



4

POSITION THE MACHINE

Position the MACHINE onto the desired area to clean.



5

TURN MACHINE ON

Push the POWER SWITCH to “FLOOR CLEANING” position.



6

RELEASE THE HANDLE

Step on the HANDLE RELEASE PEDAL to pull back/release the MAIN HANDLE.



7

CLEANING YOUR HARD FLOORS

Press the SPRAY & CLEAN button to apply solution while making 2 slow wet passes (1 forward and 1 backward) over each area. Release SPRAY & CLEAN button. Press Spray & Clean Trigger. Make 2 slow dry passes (1 forward and 1 backward) to suck up the dirty solution [DO NOT hold down the SPRAY & CLEAN button for this step].



8

LEAVE THE MACHINE ON FOR 15 SECONDS

Leave the machine on for 15 seconds after cleaning to allow for all of the dirty solution to be collected into the DIRTY WATER TANK.



EMPTYING THE DIRTY WATER TANK



IMPORTANT: Empty the **DIRTY WATER TANK** before the dirty water reaches the “**FULL LINE.**”

1

TURN THE MACHINE OFF

Press the **POWER SWITCH** to the “**OFF**” position.



2

UNPLUG THE POWER CORD

Unplug the **POWER CORD** from the outlet and wrap it around the **POWER CORD WRAP**.

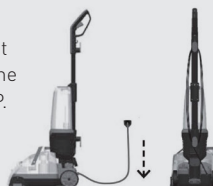

3

REMOVE THE DIRTY WATER TANK

Remove the **DIRTY WATER TANK** by grasping the **TANK HANDLE** and lifting straight up.



4

EMPTY THE DIRTY WATER

Unscrew the **DIRTY WATER CAP** counter-clockwise and set aside. Pour out the dirty water. Rinse out the **DIRTY WATER TANK** thoroughly with warm water. Replace **DIRTY WATER CAP**.
NOTE: DO NOT pour into sink or tub. Dirty water should be poured into toilet or outside.



5

SECURE THE DIRTY WATER TANK

Place the **DIRTY WATER TANK** back onto the machine by setting it straight down on the base.



6

FOR A DEEPER CLEAN

To clean the **DIRTY WATER TANK** more thoroughly:

1. Turn the **DIRTY WATER TANK** upside down to locate the **FLOAT CAP**.
2. Unscrew the **FLOAT CAP** turning counterclockwise.
3. Remove the **FLOAT ASSEMBLY**. Clean inside the tank with a towel or a cleaning brush.
4. Replace the **FLOAT ASSEMBLY**. Firmly tighten the **DIRTY WATER CAP** by turning clockwise until tightened.



CLEANING UP

1

TURN THE MACHINE OFF

Press the POWER SWITCH to the "OFF" position.



2

UNPLUG THE POWER CORD

Unplug the POWER CORD from the outlet and wrap it around the POWER CORD WRAP.

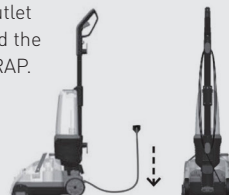

3

RINSE THE CLEAN WATER TANK

Press the CLEAN WATER TANK RELEASE button and remove the CLEAN WATER TANK from the machine. Rinse thoroughly with warm water. Allow tank to dry thoroughly to prevent odour when stored. Replace on the machine when ready.



4

EMPTY THE DIRTY WATER

Remove the DIRTY WATER TANK using the TANK HANDLE. Rinse the inside of the DIRTY WATER TANK thoroughly with warm water. Allow tank to dry thoroughly to prevent odour when stored. Replace on the machine when ready.

Refer to "Emptying the DIRTY WATER TANK" instructions on Page 10 for additional deep cleaning details.



5

STORE THE MACHINE

Move the machine to a closet or storage place. DO NOT place or store the machine on floors that may be damaged by water.



CLEANING THE BRUSH ROLL

1

TURN THE MACHINE OFF

Push the POWER SWITCH to the "OFF" position and unplug the machine.



2

GENTLY LAY THE MACHINE DOWN ON ITS SIDE

Remove the CLEAN WATER TANK and DIRTY WATER TANK. Gently position the machine on its side to access the BRUSH ROLL.



3

REMOVE ANY DEBRIS FROM BRUSH ROLL



HOW TO CHANGE THE BRUSH ROLL

1

TURN THE MACHINE OFF

Push the POWER SWITCH to the "OFF" position and unplug the machine.



2

REMOVE THE TANKS

Remove the CLEAN WATER TANK and DIRTY WATER TANK and set aside.



3

LAY THE MACHINE ON ITS SIDE



Gently lay the machine down on its side.

4

UNLOCK THE BRUSH ROLL LOCK

Turn the BRUSH ROLL LOCK to the UNLOCK position using coin or screwdriver.



5

REMOVE BRUSH ROLL LOCK COVER

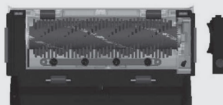

6

REPLACE THE BRUSH ROLL

Remove old BRUSH ROLL and replace with NEW BRUSH ROLL.



7

REPLACE BRUSH ROLL LOCK COVER

Turn the BRUSH ROLL LOCK to the LOCK position using a coin or screwdriver.



8

MOVE MACHINE INTO UPRIGHT POSITION

Replace DIRTY WATER TANK and CLEAN WATER TANK.



9

NOW YOU ARE READY TO CLEAN



TROUBLESHOOTING

The following Troubleshooting Guide is provided to help you resolve issues that may arise with common usage of the machine.

PROBLEM	POSSIBLE REASON	HOW TO FIX
No Power	<ul style="list-style-type: none"> Power cord not plugged in. Power outlet not switched on 	<ul style="list-style-type: none"> Plug power cord into power outlet Press Power Button to "Floor Clean."
No / Low Spray, Machine	<ul style="list-style-type: none"> Not pressing Spray & Clean Trigger. Clean Water tank is empty or low Clean Water Tank is not locked or installed correctly Valve of Clean Water Tank is clogged 	<ul style="list-style-type: none"> Press and hold Spray & Clean Trigger. Fill Clean Water Tank with water and solution. Lift up Clean Water Tank, and place back into position. Tank should click into place when positioned properly. Remove valve from bottom of Clean Water Tank Clean with warm soapy water.
No / Low Suction Machine	<ul style="list-style-type: none"> Dirty Water tank is full Dirty Water tank is not installed correctly Nozzle is not properly installed 	<ul style="list-style-type: none"> Empty Dirty Water Tank and replace empty tank when finished. Lift up Dirty Water Tank and place back into position. Disconnect Nozzle. Reconnect Nozzle ensuring the tabs are latched at the bottom and the latch is fully engaged.
Rotating Brush Not Rotating	<ul style="list-style-type: none"> If something is lodged in the Brush Roll, brush will stop rotating 	<ul style="list-style-type: none"> Turn machine off and unplug Power Cord from outlet. Check that there is nothing stopping the Brush Roll from rotating. The Brush Roll can be removed by unlocking the cover with a coin or screwdriver on the bottom of the machine Clean and check the Brush Roll spins freely. Replace the Brush Roll and secure by locking the Brush Roll cover. Then plug in the Machine and turn the Machine on to continue cleaning.

Should you require additional assistance contact:

CUSTOMER SERVICE

Phone: 1800 804 973

Email: customerservice@rugdoctor.com.au

Website: rugdoctor.com.au

Monday – Friday:

9:00am – 5:00pm

Saturday & Sunday:

10:00am – 5:00pm

Public Holidays:

10:00am – 5:00pm

Closed:

Good Friday
Christmas Day
Boxing Day

WARRANTY AGAINST DEFECTS

Rug Doctor Machines and Tools are manufactured, tested and inspected in accordance with the highest standards. We provide a limited warranty period (see Warranty Against Defects Period below) to give you peace of mind. This applies in addition to any statutory rights which remain unaffected. You are welcome to contact our Customer Service helpline on 1800 804 973 Monday to Friday (9:00am to 5:00pm) to discuss any warranty information.

This warranty is intended for Machines and Upholstery Tool used for ^domestic and private use and does not cover commercial* usage.

WHAT DOES THIS WARRANTY AGAINST DEFECTS COVER?

Our goods come with guarantees that cannot be excluded under the Australian Consumer Law. You are entitled to a replacement or refund for a major failure and for compensation for any other reasonably foreseeable loss or damage. You are also entitled to have the goods repaired or replaced if the goods fail to be of acceptable quality and the failure does not amount to a major failure.

This Warranty Against Defects ("Warranty Against Defects") does not impact, limit, reduce or change (or purport to impact, limit, reduce or change) any of the statutory warranties and must be read separately. Under this Warranty Against Defects, we warrant as follows:

1. Carpet Machine Hire Pty Ltd ("Carpet Machine Hire") guarantees to the original purchaser for the Warranty Against Defects Period, the machine or wand supplied by Carpet Machine Hire and every component part thereof (collectively, "Machine" and/or "Upholstery Tool") shall be free from material defects. However, this guarantee is subject to Clauses 1.2, 1.3 and 1.4 and does not apply in the circumstances described in Clause 2.1
2. Subject to Clause 2.1, you can make a claim under this Warranty Against Defects if:
 - a) you give notice (in accordance with the "How Do I Claim Under This Warranty Against Defects" section (below)) to Carpet Machine Hire during the Warranty Against Defects Period, and
 - b) you (if asked to do so by Carpet Machine Hire) return the Machine and/or Upholstery Tool to Carpet Machine Hire's place of business or an alternative address as instructed by Carpet Machine Hire, and
 - c) where relevant Carpet Machine Hire is given a reasonable opportunity of examining the Machine and/or Upholstery Tool.

Once Carpet Machine Hire receives your Machine and/or Upholstery Tool, it will be assessed. If your Machine and/or Upholstery Tool suffers a defect within the Warranty Against Defects Period, Carpet Machine Hire will either repair or replace the Machine and/or Upholstery Tool without further charge or refund you (either in part or in full).

3. The guarantee at Clause 1.1 shall apply to any replacement Machine and/or Upholstery Tool (for the Warranty Against Defects Period from the date of delivery of the replacement Machine and/or Upholstery Tool) and any repaired Machine (for the original Warranty Against Defects Period from the original date of purchase and delivery of the Machine and/or Upholstery Tool) supplied by Carpet Machine Hire.
4. This Warranty Against Defects is given in addition to and does not affect any rights and remedies available to you under Australian Consumer Law.

WARRANTY AGAINST DEFECTS PERIOD

Product	Model Number	Warranty Against Defects Period
Rug Doctor X3 Deep Cleaner	95521	1 year
Rug Doctor Spot Cleaner	93306	2 years
Rug Doctor Deep Cleaner	93170	2 years
Rug Doctor Pet Spot Cleaner	93407	2 years
Rug Doctor FlexClean	93391	2 years
Rug Doctor Upholstery Tool	91647	1 year

WHAT THE WARRANTY AGAINST DEFECTS DOES NOT COVER

- 2.1 Subject to any statutory rights which remain unaffected, the guarantee at Clause 1.1 does not apply to any defect in the Machine and/or Upholstery Tool arising from:
- a) any further use of the Machine and/or Upholstery Tool made by you or any third party after giving notice in accordance with Clause 1.2
 - b) your failure, or that of any third party, to follow Carpet Machine Hire's reasonable oral or written instructions (including but not limited to the User Guide supplied with the Machine) as to the proper storage, use and maintenance of the Machine (as to the latter, for best operating efficiency and cleaning use of only Carpet Machine Hire's cleaning products is recommended)
 - c) any alteration or repair, or attempted alteration or repair of the Machine and/or Upholstery Tool, by you or any third party without written consent of Carpet Machine Hire
 - d) fair wear and tear, wilful damage, negligence by you or any third party, accident, improper use and abuse, or abnormal storage or working conditions; or
 - e) use by you or any third party of the Machine and/or Upholstery Tool in any way or at any time for rental or hire purposes.

EXPENSES

If a Machine and/or Upholstery Tool is returned to Carpet Machine Hire for repair under the guarantee at Clause 1.1, Carpet Machine Hire will pay these delivery charges. However, you will be responsible for paying any delivery charges for Carpet Machine Hire sending the Machine and/or Upholstery Tool back to you if the Machine and/or Upholstery Tool is not considered by Carpet Machine Hire, acting reasonably, to have a material defect.

Subject to law, you will be responsible for paying any delivery charges for sending the Machine and/or Upholstery Tool to and from Carpet Machine Hire for repairs occurring outside of the Warranty Against Defects Period.

HOW DO I CLAIM UNDER THIS WARRANTY AGAINST DEFECTS?

To obtain warranty assistance, contact the Carpet Machine Hire Customer Support team using the details below. Carpet Machine Hire will require the following information in order to assist you: your name, address and telephone number, model number, serial number, proof of purchase showing the date and place of purchase and a detailed explanation of the nature of the problem. Carpet Machine Hire will review all the facts involved and advise you as to the correct procedure. Carpet Machine Hire recommends you keep the original carton and packaging materials.

Contact information:

CARPET MACHINE HIRE PTY LTD

ABN: 79 008 665 932

Unit 10 | 25-37 Chapman Street Blackburn North
VIC 3130

Phone: 1800 804 973

(Monday to Friday 9:00am to 5:00pm AEST/AEDT)

Email: customerservice@rugdoctor.com

Website: rugdoctor.com.au

AFTER THE WARRANTY AGAINST DEFECTS PERIOD EXPIRES

After the Warranty Against Defects Period expires, Carpet Machine Hire agrees to carry out any maintenance of the Machine and/or Upholstery Tool in a prompt and efficient manner. Subject to law, you agree to pay a designated hourly rate for maintenance plus any applicable costs including (without limitation) replacement parts and freight costs.

^ Domestic and private use only. You agree not to use the Machine or Upholstery Tool for any commercial, business or re-sale purposes. IN the event that you do, Carpet Machine Hire does not accept any liability to you for any loss of profit, loss of business, business interruption, or loss of business opportunity to the fullest extent permissible by law.

* Commercial use applies when Machine or Upholstery Tool is being used in a non-domestic capacity.

